

08-21-09

TOOLS NEEDED:	PHILLIPS SCREWDRIVER	8MM SOCKET	5MM ALLEN WRENCH	8MM WRENCH
	CLEAR SILICONE	1/8"-1/2" DRILL BITS	DRILL	MASKING TAPE
	SCISSORS	THREADLOCKER	KNIFE OR RAZOR BLADE	AWL

**NOTE: WE RECOMMEND USING THREADLOCKER ON ALL HARDWARE INSTALLED.**

**NOTE: READ INSTRUCTIONS BEFORE PROCEEDING.**

### INSTALLATION:

1. PLACE BIKE ON CENTER STAND.
2. WITH THE PHILLIPS SCREWDRIVER REMOVE THE SCREW (1A) FROM THE RIGHT SADDLEBAG LID CYLINDER ARM (1B) AND THE SCREW (1C) FROM THE STOP CHORD (1D).
3. USING A PHILLIPS SCREWDRIVER REMOVE THE FOUR SCREWS (1E) HOLDING THE SADDLEBAG DOOR HINGE TO THE RIGHT SADDLEBAG.
4. USING THE PHILLIPS SCREWDRIVER REMOVE THE THREE SCREWS (2A) HOLDING THE OEM AIR DAM (2B) TO THE SADDLEBAG DOOR (1F). INSTALL THE NEW CHROME AIR DAM REUSING THE OEM SCREWS (2A) IN REVERSE ORDER OF REMOVAL.
5. REINSTALL THE SADDLEBAG DOOR (1F) IN REVERSE ORDER OF STEPS 2 AND 3.
6. WITH AN 8MM SOCKET REMOVE THE 3 ACORN NUTS FROM THE BACK OF THE RIGHT SADDLEBAG LIGHT AND REMOVE THE LIGHT.
7. DISCONNECT THE CONNECTOR FROM THE BOTTOM BULB SOCKET AND CONNECT THE SUPPLIED PLUG HARNESS INTO THE BULB SOCKET, THEN CONNECT THE REMOVED CONNECTOR INTO THE PLUG HARNESS.
8. REMOVE THE LARGE RUBBER GROMMET FROM THE SADDLEBAG WHERE THE LIGHT WAS LOCATED AND CUT AN X IN THE CENTER. REINSTALL THE RUBBER GROMMET AND SLIDE THE PIGTAILS FROM THE PLUG HARNESS THROUGH THE X.
9. REINSTALL THE SADDLEBAG LIGHT IN REVERSE ORDER OF STEP 1.
10. USING AN 8MM WRENCH REMOVE THE 3 BOLTS ATTACHING THE RIGHT EXHAUST TIP TO THE RIGHT EXHAUST PIPE. REMOVE THE EXHAUST TIP BY PULLING IT STRAIGHT BACK.
11. REMOVE THE OEM REAR AIR DAM (2D) BY REMOVING THE 3 PUSH PINS (2C) FROM THE INSIDE OF THE SADDLEBAG; THIS IS DONE BY PUSHING DOWN THE CENTER OF THE PIN AND PULLING THE ENTIRE PUSH PIN (2C) ASSEMBLY OUT.
12. ESTABLISH LOCATION FOR THE HOLE FOR THE LED AIR DAM CONNECTORS AND WIRES AS SHOWN IN DIAGRAM #3 AND CENTER MARK LOCATION WITH AWL.
13. USING A 1/8" DRILL BIT; DRILL A PILOT HOLE THROUGH THE BOTTOM OF THE SADDLEBAG ON THE CENTER MARK (3B). CONTINUE STEPPING UP IN SIZE UNTIL A 1/2" HOLE IS DRILLED.
14. FEED THE LED AIR DAM CONNECTORS AND WIRES THROUGH THE 1/2" HOLE AND FASTEN DOWN THE AIR DAM BY LOOSELY INSTALLING THE PROVIDED BUTTON SOCKET HEAD CAP SCREW INTO THE OUTER MOUNTING HOLE AND THEN INSERTING TWO OF THE OEM PUSH PINS (2C) INTO THE TWO INNER MOUNTING HOLES. USING A 5MM ALLEN WRENCH TIGHTEN THE BUTTON SOCKET HEAD CAP SCREW.
15. CONNECT THE LED AIR DAM WIRES INTO ONE OF THE PIGTAILS FROM THE PLUG HARNESS.
16. TEST THE FUNCTION OF THE LIGHTS TO MAKE SURE THEY ARE FUNCTIONING PROPERLY.
17. COVER THE BOTTOM OF THE DRILLED HOLE WITH MASKING TAPE ON THE OUTSIDE OF THE SADDLEBAG, AND FROM THE INSIDE FILL THE HOLE WITH CLEAR SILICONE. ONCE THE SILICONE HAS DRIED PEEL OFF THE MASKING TAPE.
18. REINSTALL THE EXHAUST TIP IN REVERSE ORDER OF STEP 10.
19. REPEAT STEPS 1-18 FOR THE LEFT SIDE.

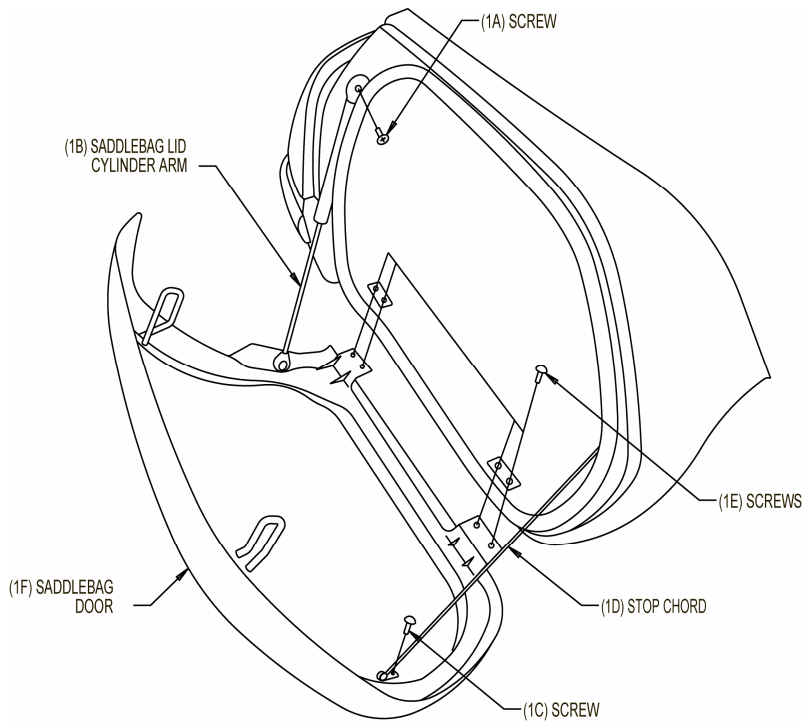

**DIAGRAM # 1**

**DIAGRAM # 2**

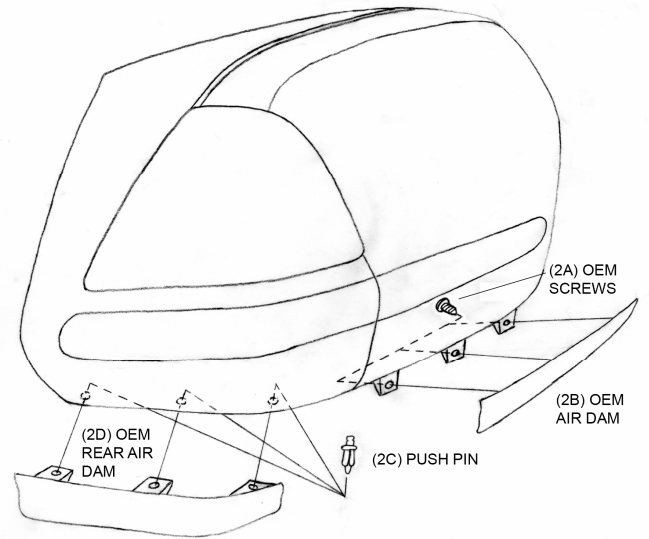

**DIAGRAM # 3**

