



ISO GRIPS/06-UP GL 1800 with OEM HEATED GRIPS 6183

PARTS INCLUDED

- 1 Right Front Cover
- 1 Right Rear Cover
- 1 Left Front Cover
- 1 Left Rear Cover
- 2 ISO Sleeves
- 1 Hardware Kit including:
 - 13 #4-40 x 3/8" Socket Head Cap Screw (SHCS)
 - 1 M6-1 x 40mm Phillips Pan Head Screw (PPHS)
 - 2 End Caps
- 1 Installation Instructions

Please read and understand entire instructions before starting installation.

THANK YOU FOR CHOOSING KÜRYAKYN!

IN ORDER TO PROTECT YOU AND OTHERS FROM POSSIBLE INJURY AND/OR PROPERTY DAMAGE OR LOSS, PLEASE PAY CLOSE ATTENTION TO ALL INSTRUCTIONS, WARNINGS, CAUTIONS AND NOTICES REGARDING THE USE AND CARE OF THIS PRODUCT.

WARNING	THIS INDICATION ALERTS YOU TO THE FACT THAT IGNORING THE CONTENTS DESCRIBED HEREIN CAN RESULT IN POTENTIAL DEATH OR SERIOUS INJURY.
NOTICE	This indication alerts you to the fact that ignoring the contents described herein may negatively affect product performance and functionality.

NOTICE	IF INSTALLING THIS PRODUCT FOR ANOTHER PARTY, PLEASE MAKE SURE THEY RECEIVE THIS COPY OF THE INSTALLATION INSTRUCTIONS SO THEY ARE AWARE OF THE IMPORTANT INFORMATION CONTAINED IN THEM.
---------------	---

TOOLS SUGGESTED

Set of Hex Wrenches, Phillips Screwdriver, General Window Cleaner

STRICTLY OBSERVE THE FOLLOWING GUIDELINES IN ORDER TO USE THE PRODUCT PROPERLY AND AVOID POTENTIALLY DANGEROUS ACCIDENTS.

STEP 1 Read and understand all steps in the instructions before starting the installation. Park the motorcycle on a hard, level surface and turn off the ignition.

STEP 2 Remove the stock bar ends by removing the Phillips head screw, these will not be reused.

STEP 3 Identify the right side (sitting on the bike) cover. PIC 1

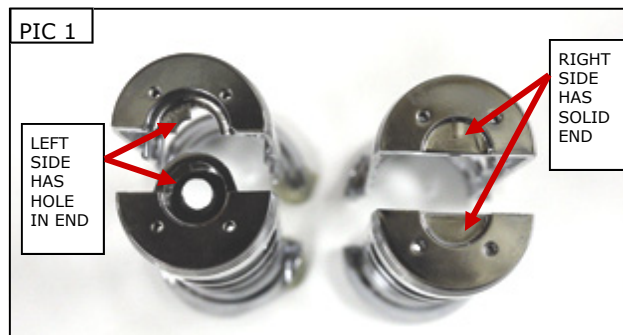

CUSTOMER SERVICE

877.370.3604 (toll free)

INSTALLATION QUESTIONS

techsupport@kuryakyn.com
or call 715.247.2983

LIMITED WARRANTY

Kuryakyn warrants that any Kuryakyn products sold hereunder, shall be free of defects in materials and workmanship for a period of one (1) year from the date of purchase by the consumer excepting the following provisions:

- Kuryakyn shall have no obligation in the event the customer is unable to provide a receipt showing the date the customer purchased the product(s).
 - The product must be properly installed, maintained and operated under normal conditions.
 - Kuryakyn makes no warranty, expressed or implied, with respect to any gold plated products.
 - Kuryakyn shall not be liable for any consequential and incidental damages, including labor and paint, resulting from failure of a Kuryakyn product, failure to deliver, delay in delivery, delivery in nonconforming condition, or for any breach of contract or duty between Kuryakyn and a customer.
- Kuryakyn products are often intended for use in specific applications. Kuryakyn makes no warranty if a Kuryakyn product is used in applications other than intended.
- Kuryakyn electrical products are warranted for one (1) year from the date of purchase by the consumer. L.E.D.'S contained in components of Kuryakyn products will be warranted for defects in materials and workmanship for 3 years from the date of purchase where as all other components shall be warranted for one(1) year. This includes, but is not limited to; control modules, wiring, chrome & other components.
- Kuryakyn makes no warranty of any kind in regard to other manufacturer's products distributed by Kuryakyn. Kuryakyn will pass on all warranties made by the manufacturer and where possible, will expedite the claim on behalf of the customer, but ultimately, responsibility for disposition of the warranty claim lies with the manufacturer.

ABOUT OUR CATALOG

For purchasing Kuryakyn® products, you can receive a complete catalog free of charge. Send the Proof-of-Purchase below with your address to: Kuryakyn, P.O. Box 339, Somerset, WI 54025. Please indicate either Accessories Catalog for Harley-Davidson® or GL & Metric Cruisers.

Be sure to ask your local dealer about other Kuryakyn® products, the motorcycle parts and accessories designed for riders by riders.

©2005 Kuryakyn USA® All Rights reserved.



STEP 4 Locate the ISO sleeve and identify the end that will slide on first (it is tapered on the inside edge.)
PIC 2

Right Side Procedure

STEP 5 See PIC 3 and PIC 4 to determine front and back covers. Place the ISO Sleeve into the right front cover with the tapered end facing towards the hand controls. PIC 5

STEP 6 Apply a small amount of window cleaner on the stock grips to ease the installation of the ISO grips.

STEP 7 Slide the ISO sleeve and front cover all the way on, ensuring that the grip heater wire is in the cover's slot and not being pinched.

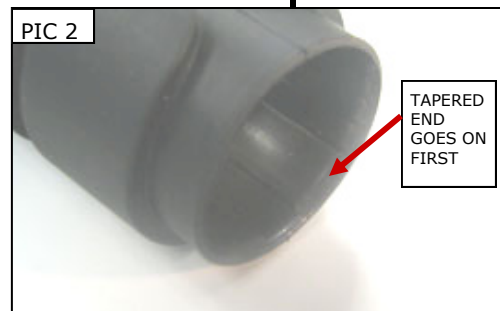

WARNING ALLOW SUFFICIENT TIME FOR THE GRIPS TO DRY BEFORE RIDING THE MOTORCYCLE. (ROUGHLY AN HOUR AT 70°). WITH TWO FINGERS CHECK TO MAKE SURE THAT THERE IS NO TWISTING OF THE COVER BEFORE RIDING. A LOOSE COVER MAY CAUSE LOSS OF CONTROL RESULTING IN SERIOUS INJURY OR DEATH.

STEP 8 Position the right side rear cover as shown in PIC 6. Ensure that the tabs in the rear cover align with the slots in the front cover; squeeze the covers together until the tabs and slots positively engage. It may be helpful to push/pull back on the rubber pads as seen in PIC 7.

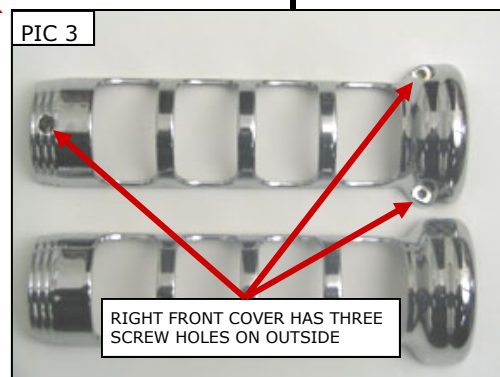

NOTE: It may help to use cable ties around the ribs on the grip cage and tighten evenly, to get the tabs and slots to positively engage. PIC 7

STEP 9 Secure the cover with the three #4-40 x 3/8" SHCS screws from the front side, finger tighten for now, their location is shown in PIC 8.

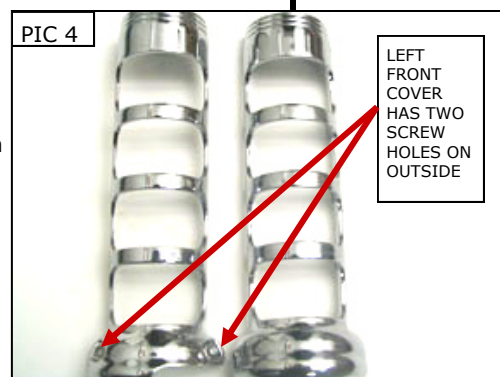

STEP 10 Position the end cap so that the four holes in the end cap align with the four holes in the covers, insert the four #4-40 x 3/8" SHCS screws; finger tighten for now. PIC 8

STEP 11 Ensuring that the grip heater wire is not pinched, tighten all the fasteners.

NOTICE Secure all wiring away from any moving parts, pinch points or extreme heat. Küryakyn WILL NOT issue a warranty on any electrical component that fails due to pinched, crimped, broken, abraded, melted or frayed wires.

STEP 12 Ensure proper throttle operation before moving onto the left side or starting the motorcycle.

WARNING ROTATE THROTTLE AND CHECK THAT IT MOVES FREELY AND RETURNS TO CLOSED BEFORE STARTING BIKE. FAILURE OF THE THROTTLE TO PROPERLY RETURN COULD RESULT IN LOSS OF CONTROL CAUSING SERIOUS INJURY OR DEATH.

NOTICE It is the installer's responsibility to ensure that all of the fasteners (including pre-assembled) are tightened before operation of the motorcycle. Küryakyn will not provide warranty coverage on products or components lost due to improper installation or lack of maintenance. Periodic inspection and maintenance are required on all fasteners.

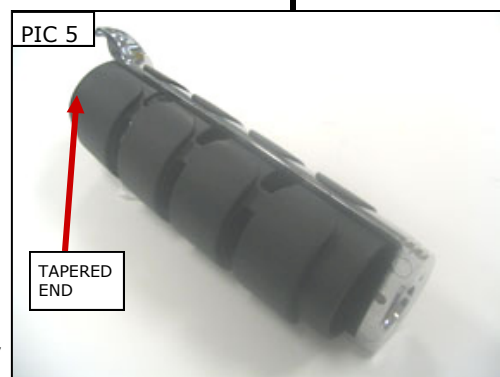

Left Side Procedure

STEP 13 Repeat STEP 4 through STEP 8 using the left side covers instead of right.

STEP 14 Insert the M6-1 x 40mm Phillips Pan Head Screw (PPHS) in the end of the grips, leaving loose for now, PIC 9

STEP 15 Insert the two #4-40 x 3/8" SHCS screws from the front side, ensure that the grip heater wire is not pinched and fully tighten the fasteners, PIC 10

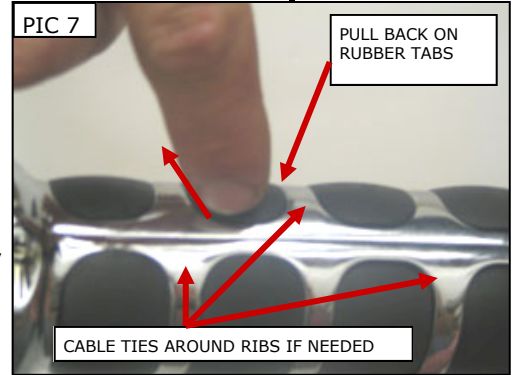
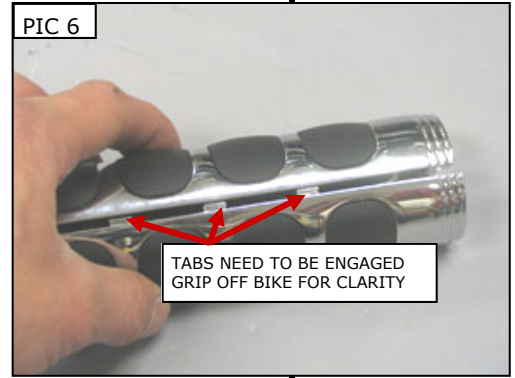

NOTICE Secure all wiring away from any moving parts, pinch points or extreme heat. Küryakyn WILL NOT issue a warranty on any electrical component that fails due to pinched, crimped, broken, abraded, melted or frayed wires.

STEP 16 Tighten the M6-1 x 40mm PPHS screw from STEP 14.

STEP 17 Position the end cap so that the four holes in the end cap align with the holes in the covers and secure with the four #4-40 x 3/8" SHCS screws, fully tightening them. PIC 8

STEP 18 Ensure that all the fasteners have been tightened and that the ISO grips do not interfere with the functions of the controls before riding the motorcycle.



NOTICE It is the installer's responsibility to ensure that all of the fasteners (including pre-assembled) are tightened before operation of the motorcycle. Küryakyn will not provide warranty coverage on products or components lost due to improper installation or lack of maintenance. Periodic inspection and maintenance are required on all fasteners.

